

2.40 mm Adapters

DC to 50.0 GHz

Application:

- DC to 50.0 GHz High Performance

Features:

- Mode Free Through 50.0 GHz.
- Low VSWR:
DC to 27.0 GHz.....1.10:1 max.
27.0 to 40.0 GHz.....1.15:1 max.
40.0 to 50.0 GHz.....1.20:1 max.
- Minimum VSWR Contribution
When Used as Connector Savers
- Performance Consistency Unit-to-unit
- Temperature Rating -55°C to +135°C

Interface:

- Per MIL-STD-348
2.40 mm Figs. 324-1 and 324-2

Construction:

- Housing: Stainless Steel, Passivated
- Contact: Beryllium Copper (BeCu)
Gold Plated Per MIL-G-45204
- Center Contact Capture:
Ultem 1000 Per ASTM D 5205
and KEL-F Per ASTM D 1430

2.40 mm (f) to (m) (50 GHz)



Model 1430-00SF

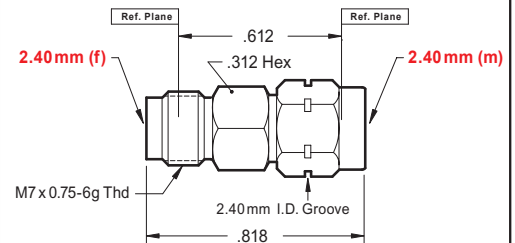

2.40 mm (m) to (m) (50 GHz)



Model 1431-00SF

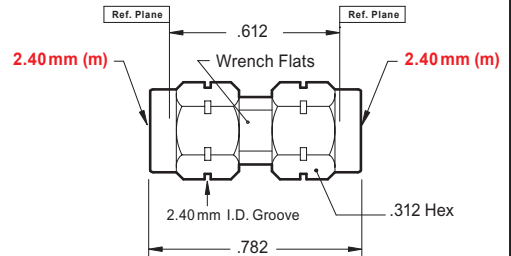

2.40 mm (f) to (f) (50 GHz)



Model 1432-00SF

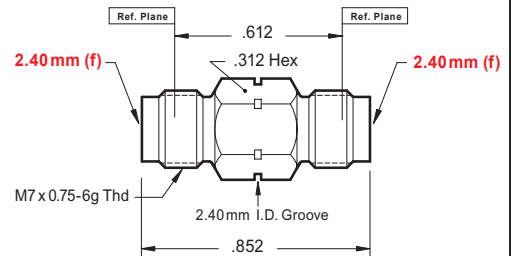

2.40 mm to 2.40 mm (Model # 1431-00SF) Test Data

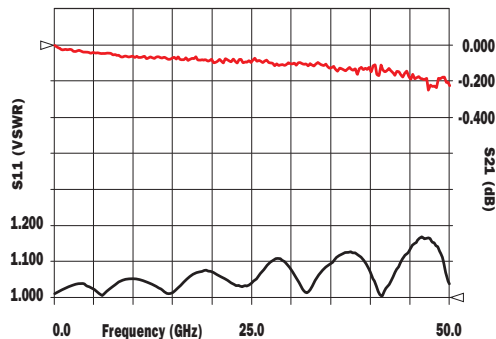

All Southwest Microwave Models are Suitable for Space / Hi-Rel Applications (see page 109).